

N00025

Mersen DIN Fuse gG DIN Size 000 500V AC 25A



PANELBOARDS



MODULAR



Component type	HRC fuse
Range	DIN Fuses
Model	N/A
Product status	Existing

NHP's DIN Fuses are designed to meet the physical size standards set by the industry, ensuring compatibility with a wide range of equipment and systems. NHP fuses conform to the DIN standard, which is recognised and accepted as the industry standard for fuse sizing and performance.

ELECTRICAL

Type of current	AC
Rated voltage AC	500 V
Utilization category	gL/gG (cable protection/equipment protection)
Breaking capacity	120 kA

CONSTRUCTION

Fuse construction type according to IEC 60269	0
---	---

DIMENSIONS

Height	40 mm
Width	21 mm
Depth	78 mm
Weight	0.13 kg

N00025

Mersen DIN Fuse gG DIN Size 000 500V AC 25A



PANELBOARDS



MODULAR

DIMENSIONAL DIAGRAM

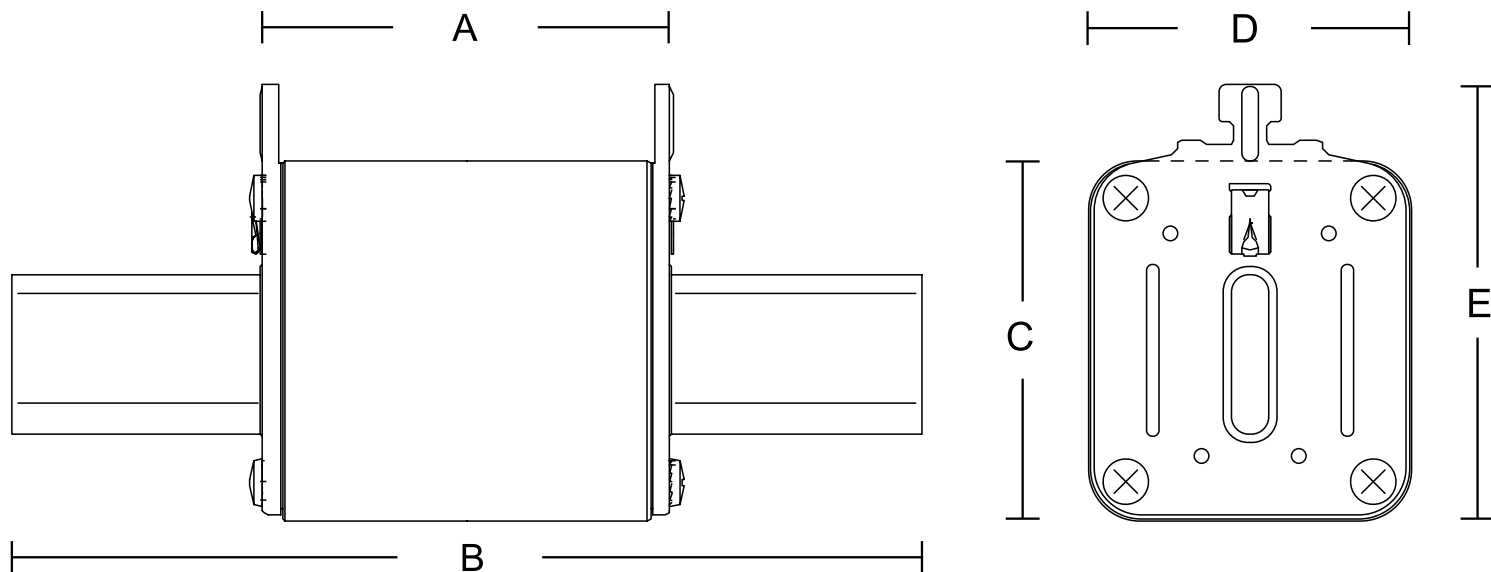

Series	Size Reference	A Body Length	B Body + Tags	C Body Height	D Body Width	E Body Height + Gripping Lugs
N000 6 – 125	000	49.0	78.0	40.0	21.0	52.5
N00 125 – 160	00	49.0	78.0	48.0	30.0	58.5
N1 16 – 160	1	65.0	135.0	46.0	28.0	65.0
N1 200 – 250	1	65.0	135.0	46.0	46.0	58.5
N2 36 – 160	2	65.0	150.0	46.0	28.0	72.5
N2 200 – 250	2	65.0	150.0	47.5	47.5	70.0
N2 300 – 400	2	65.0	150.0	56.0	56.0	71.0
N3 315 – 400	3	68.0	150.0	56.5	57.0	84.0
N3 425 – 630	3	66.0	150.0	66.5	67.0	84.0
N4 800	4	90	203	110	105	121
N4 900	4	90	203	110	105	121
N4 1000	4	90	203	110	105	121
N4 1250	4	90	203	110	105	121
N4 1600	4	90	203	110	105	121