



INSTALLATION INSTRUCTIONS

AC MAX POST (SINGLE / DOUBLE)

This document provides guidance on the installation of an AC MAX post. It should be used in conjunction with the installation and operation manual supplied with the AC MAX charger product



SCAN ME

All dimensions in mm

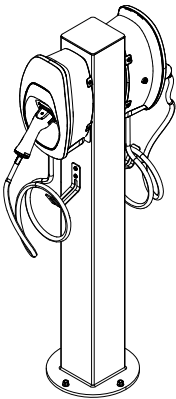
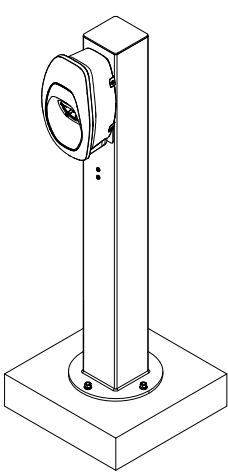

TOOLS REQUIRED (not included)

T1

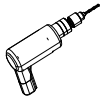

Drill Masonry
Ø12mm bit

T2

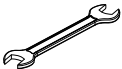

Spanner
19mm

T3

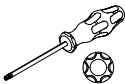

Torx T20
Screwdriver

T4

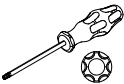

Torx T30
Screwdriver

T5

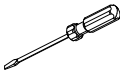

Screwdriver
Flathead

CONSUMABLES (not included)

G (4 qty)

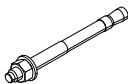

RAMSET Trubolt
M12x100 hot
dip galvanized
or equivalent

H (1 qty)



M32 cable
gland (IP66)

I (1 qty)



(OPTIONAL)
M25 cable or
conduit gland
(IP66) to suit
data cable



Concrete
reinforcing mesh
SL81 & formwork
as per Step 1

AC MAX EV CHARGING POST (supplied)

POST
A (1 pc)

PLATE
B (1 pc)

SCREW
*C (8 pcs)

*C – M6x10 pan torx T30 head screws

Cable Mount Bracket

Charger Type	Bracket
AC MAX with cable & Type 2 plug	Supplied
AC MAX with socket	Not Supplied (Optional)

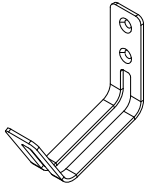

J x 1
P/No: EVPEBKT01



Wood screw
(2 pcs)

AC MAX Charger Single / Double
Single Charger – STEPS: 1-10
Double Charger – STEPS: 1-11

CHARGER
E (1 pc)

BRACKET
D (1 pc)

SCREW
*F (4 pcs)

*F – M6x10 pan torx T30 head screws

SPACE REQUIREMENT & CLEARANCES

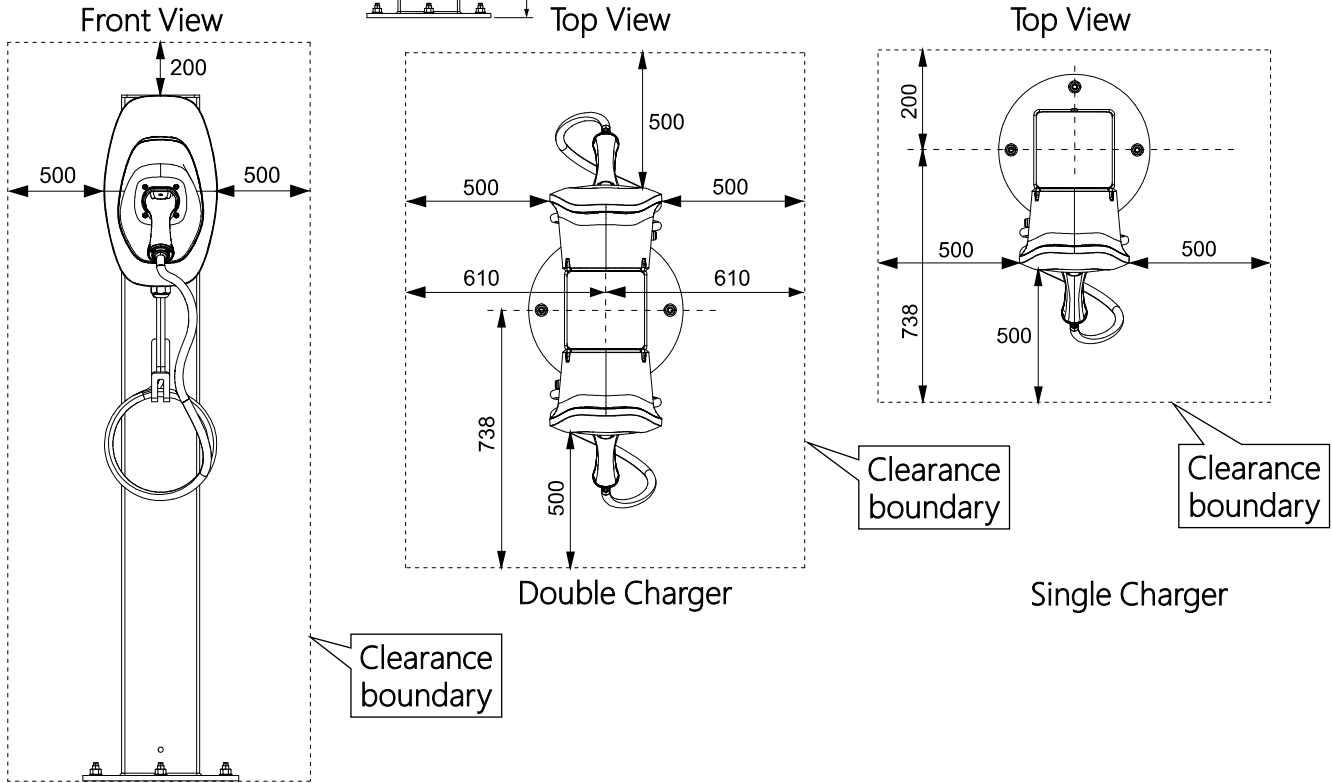
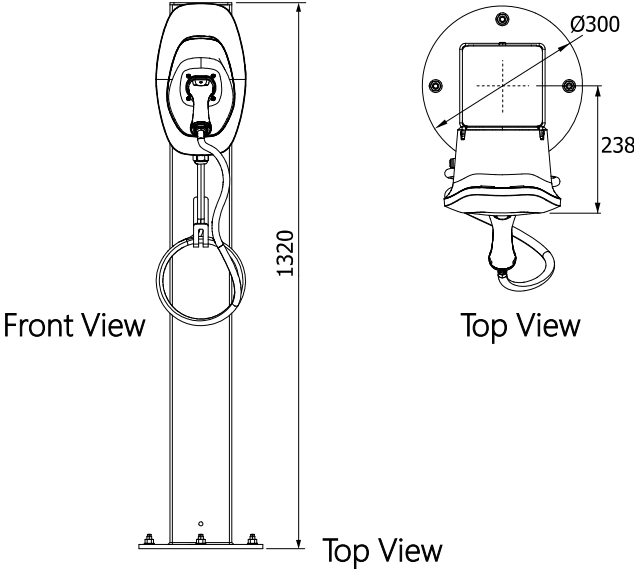

CONDUIT details

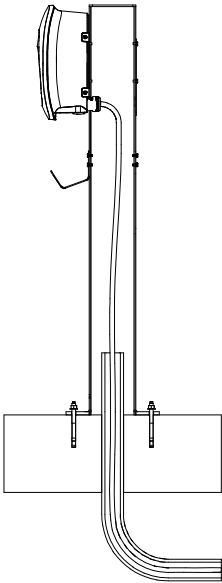
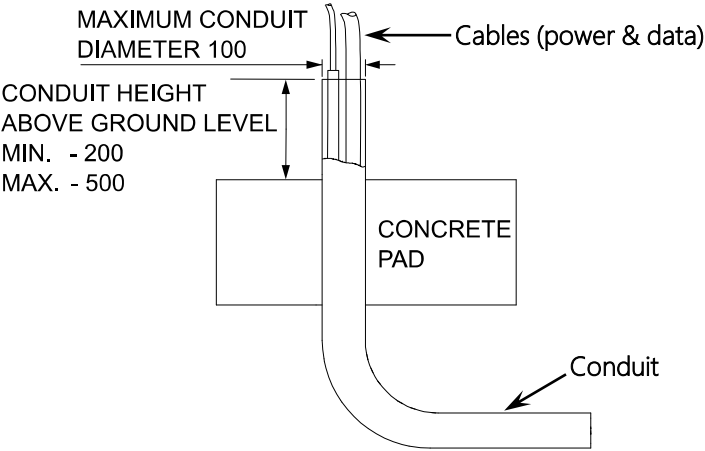

Power & data cable selection & installation as per local safety regulations
Recommended cable size:
Power cable: 10mm² (2w+E Single Phase / 4w+E Three Phase)
Data cable : CAT5 min.

STEP 1 Footing details (min 25 MPa)

Post can be installed on existing / new concrete floor or construct separate footing.

*Footing (details)

1. Dig a square hole



2. Completed hole. Install formwork if required (note 1, 2, 3)

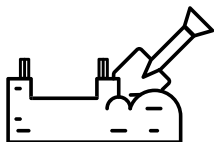

3. Mix concrete (note 6, 8)



4. Pour lean concrete sub-base. Install SL81 mesh with suitable spacers and pour full strength concrete (note 4 & 5)



5. Completed pad (note 7)

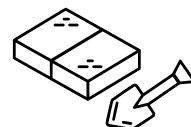

CONCRETE PAD FOOTING DETAILS

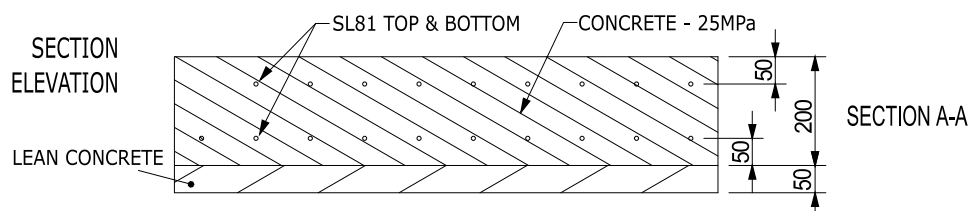
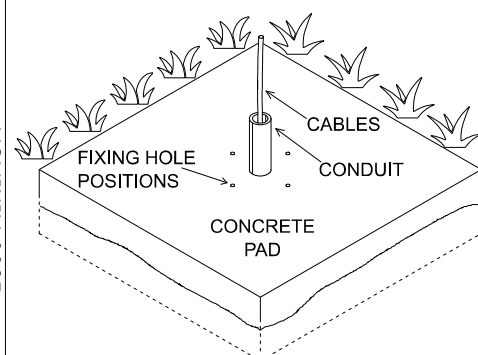
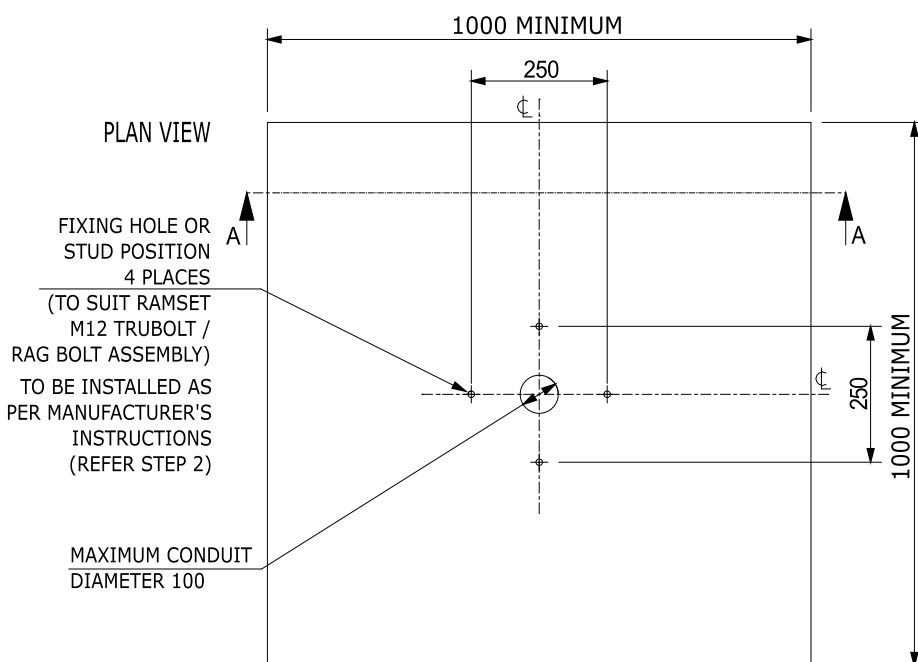

CONCRETE DETAILS (NOTES)

1. All workmanship and materials shall be in accordance with AS 3600-2018.
2. Minimum cover to all reinforcement unless otherwise shown shall be 50mm.
3. Sizes of concrete elements do not include thickness of applied finishes.
4. No holes, chases, or embedment of pipes other than shown on the structural drawings shall be made in concrete members without engineering approval.
5. Reinforcement mesh SL81. Splices in reinforcement shall be approved by the engineer.
6. Minimum grades of all concrete elements shall be 25MPa.
7. All concrete shall be moist cured for at least seven days immediately after concreting unless otherwise approved by the engineer. Formwork shall be left in place for 5 days.
8. All concrete placed shall be ready mixed concrete supplied in accordance with AS 1379-2007.

STEP 2 Install Charging Post onto Concrete Pad

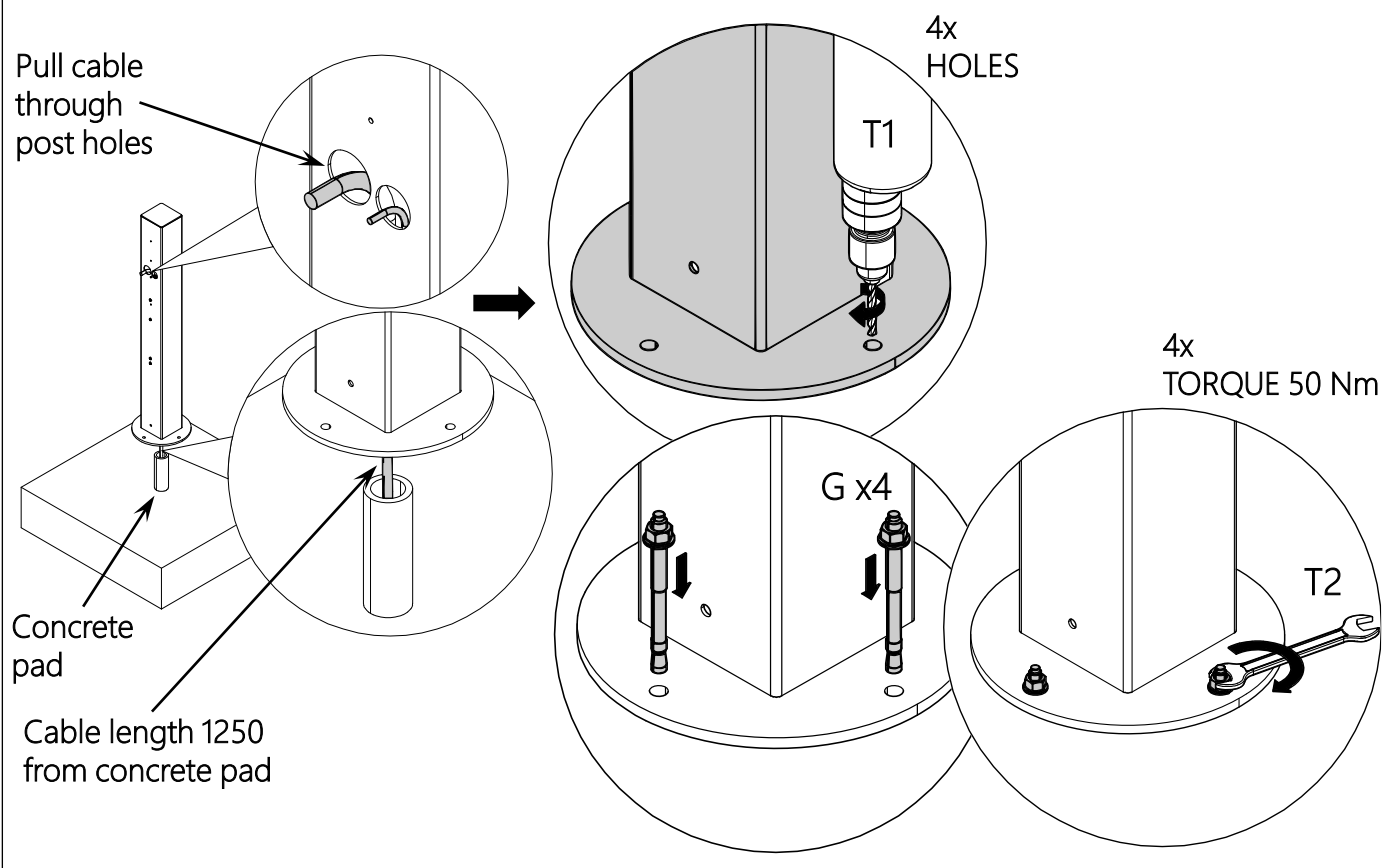

STEP 3 Install Charger Bracket to Post

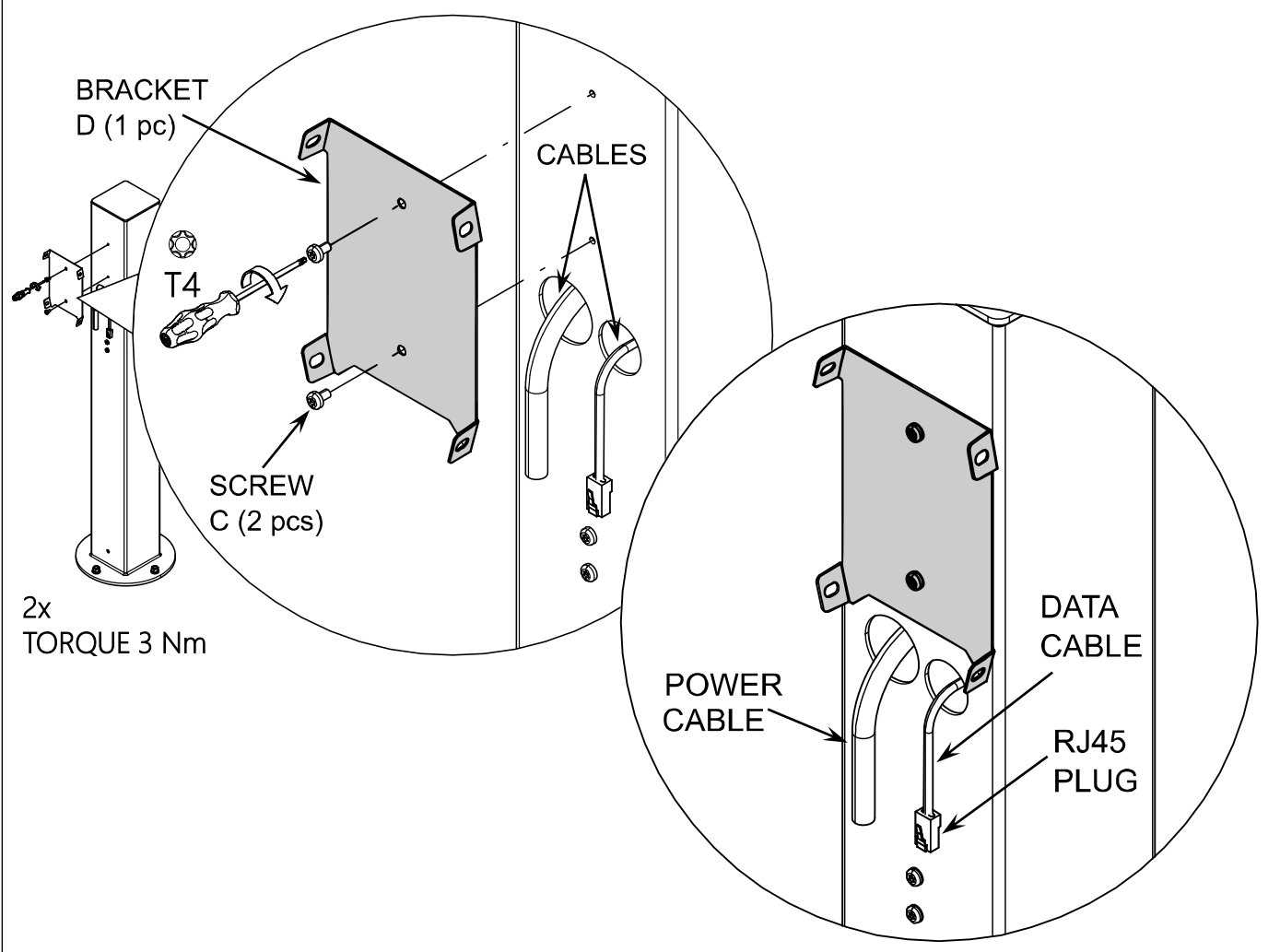

STEP 4 Remove front cover and middle cover

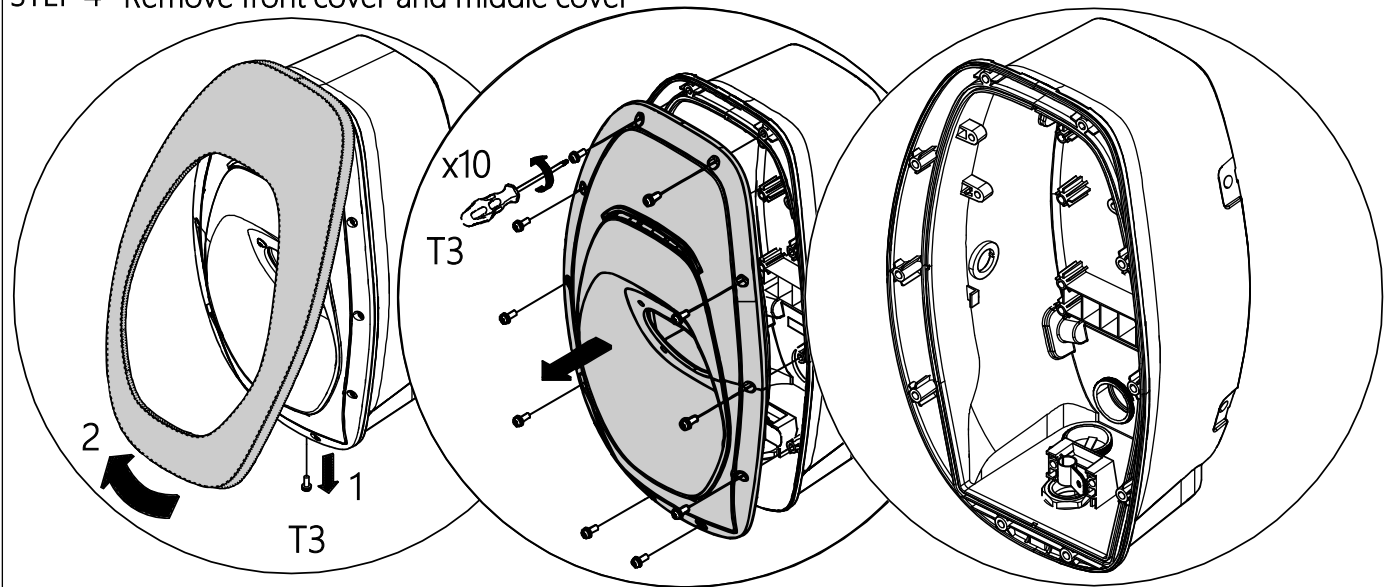

STEP 5 Assemble Cable Glands onto Charger

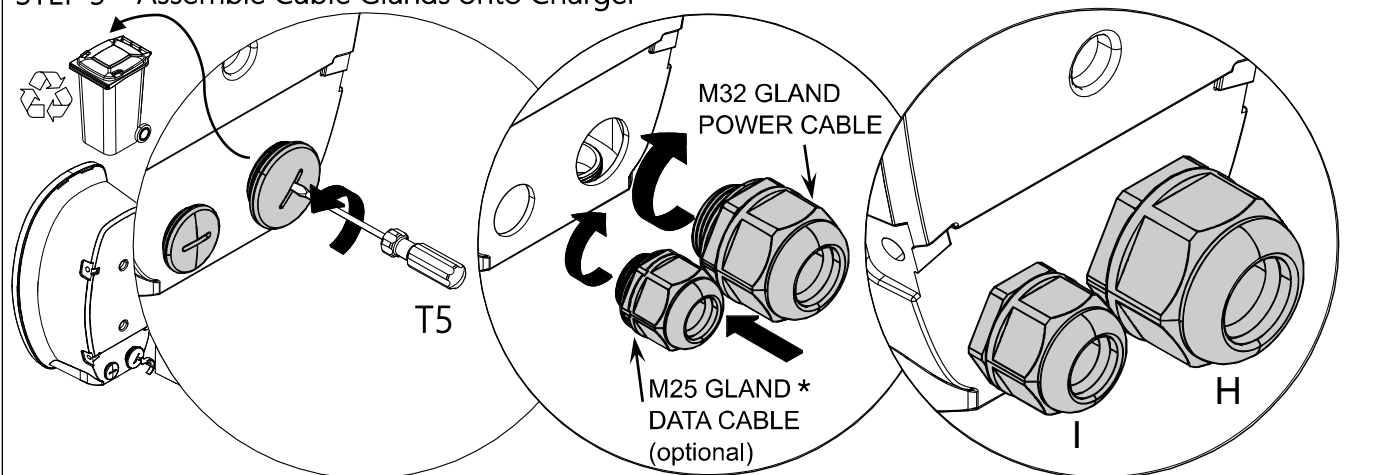

* Use appropriate cable or conduit gland for data cable

STEP 6 Assemble Charger onto Post

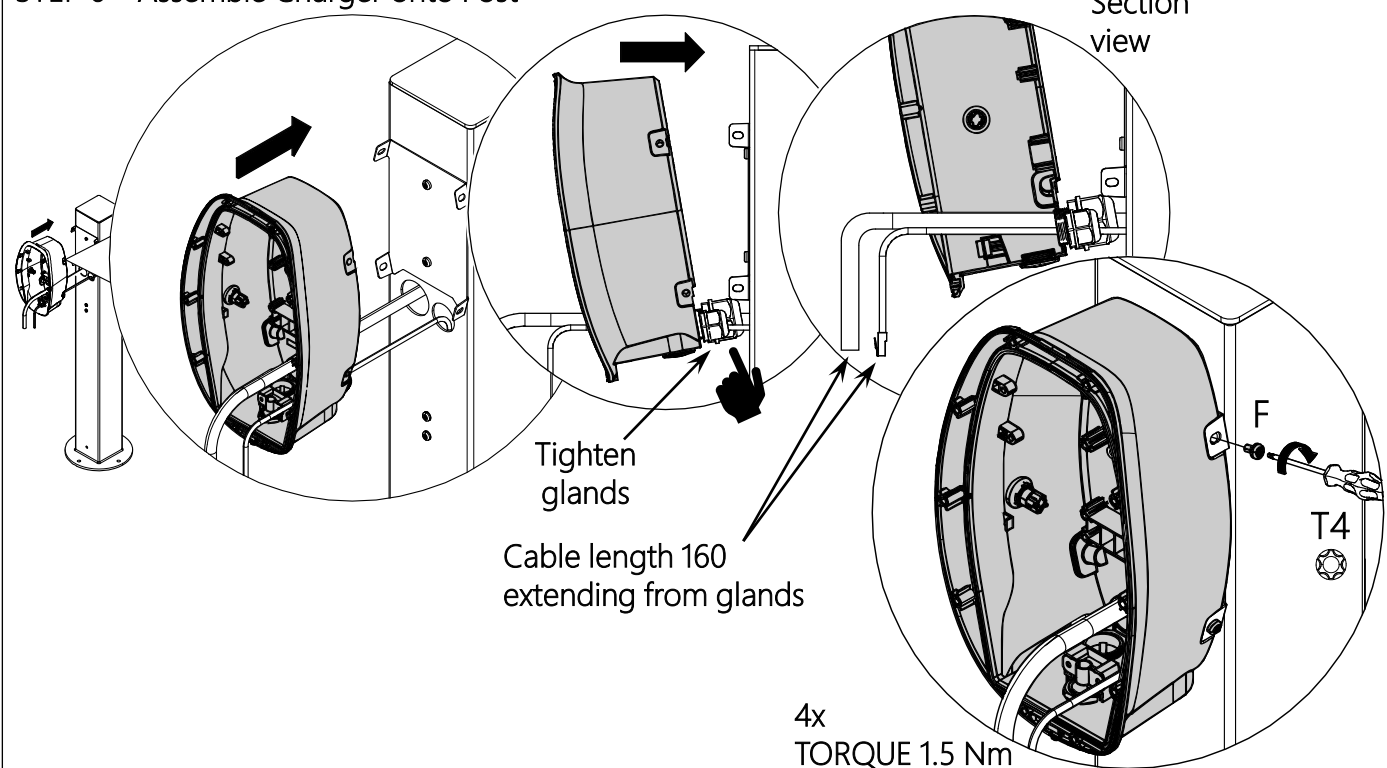

STEP 7 Connections and configurations as per AC MAX installation and operation manual

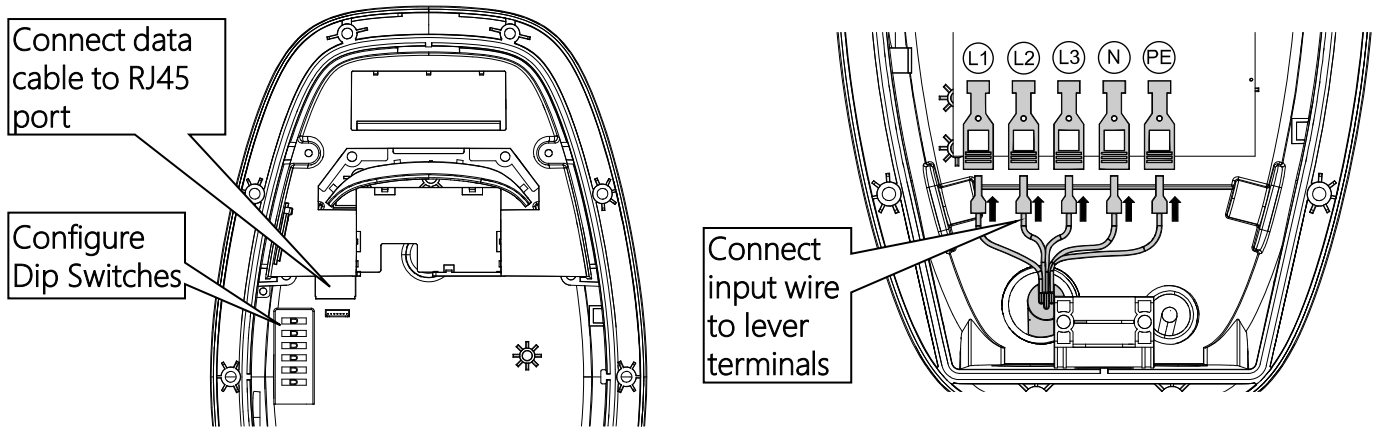

STEP 8 Reassemble front cover and middle cover

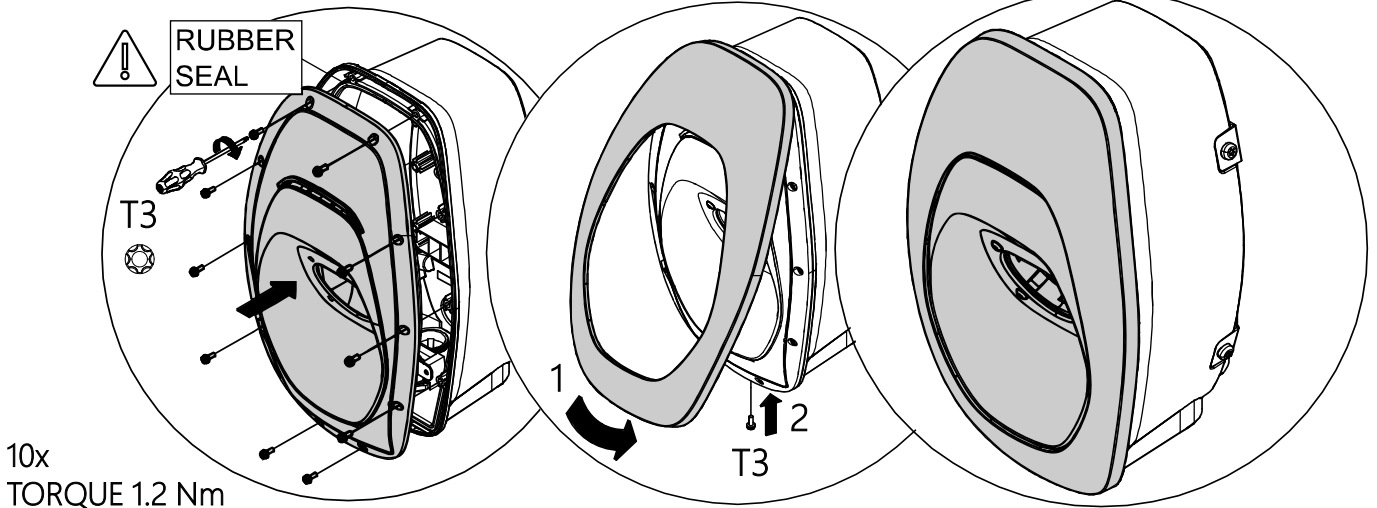

STEP 9 AC MAX Single Charger assembly

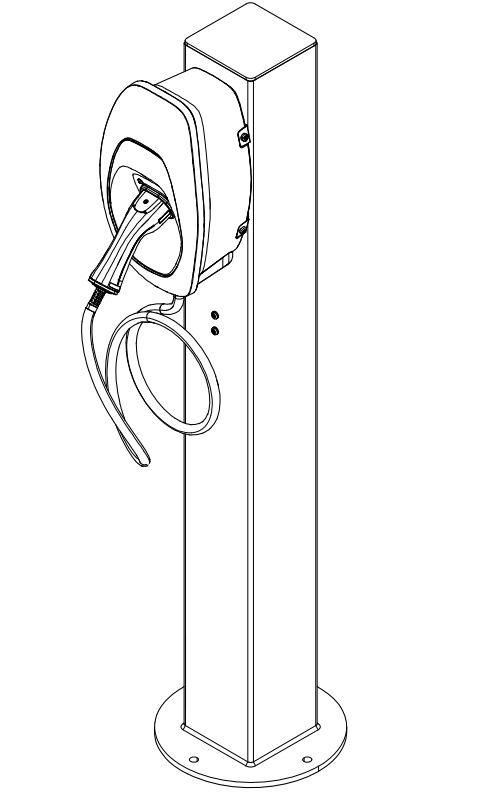

STEP 10 Fit cable bracket

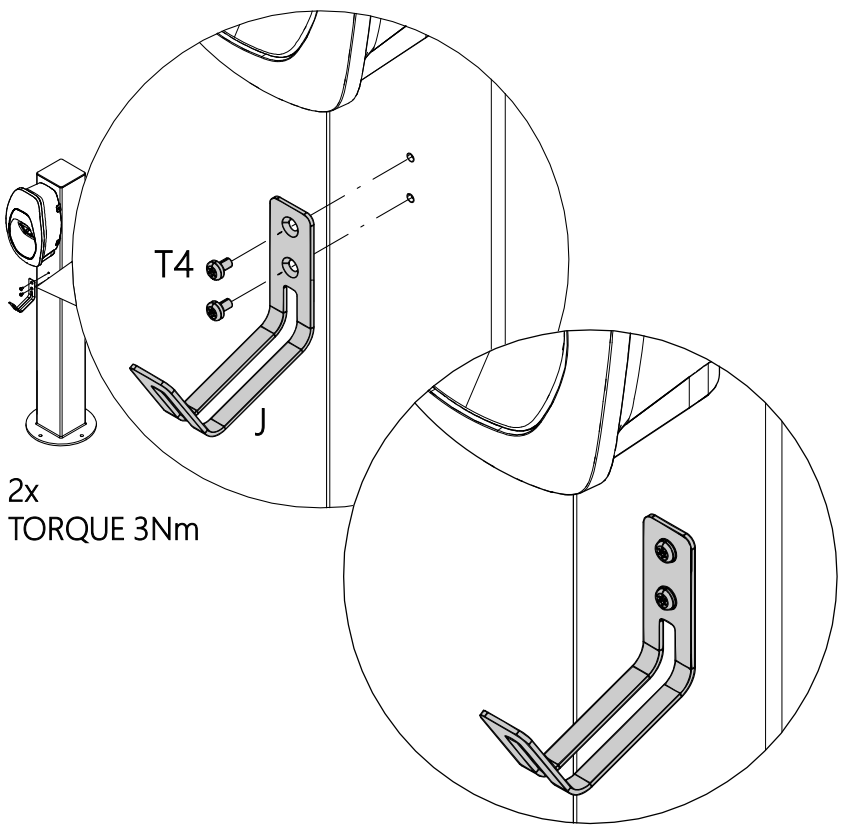

STEP 11 Second charger installation, remove blanking plate B (Repeat Steps 3-10)

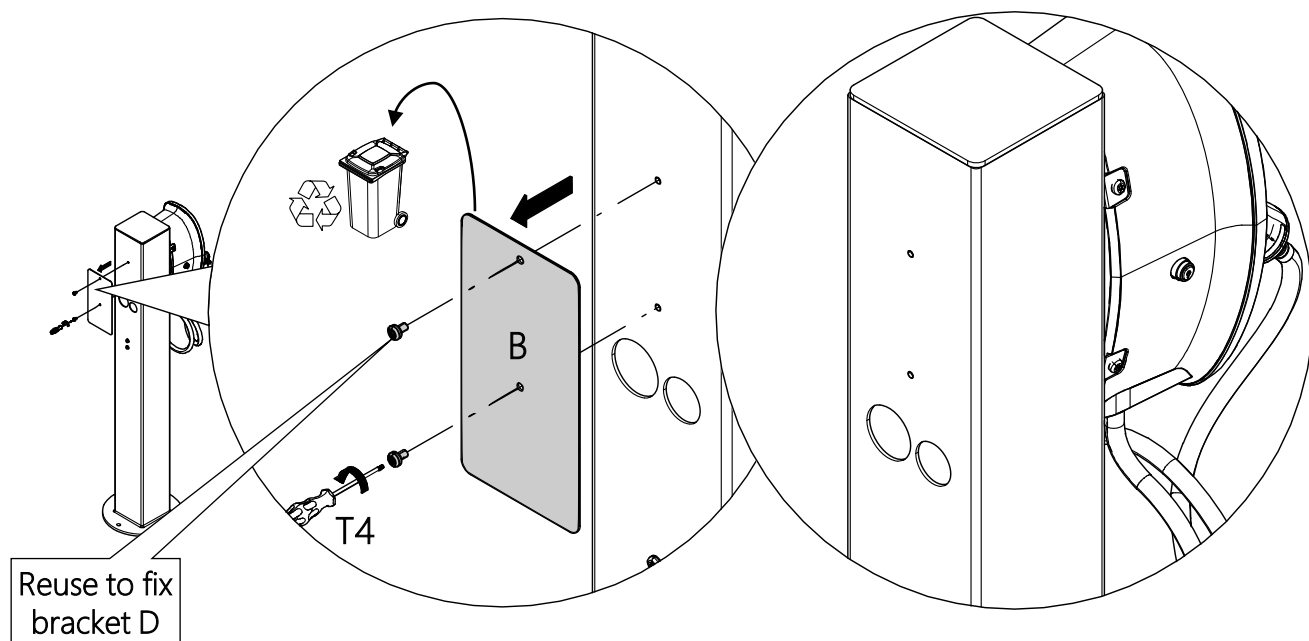

Final Assembly

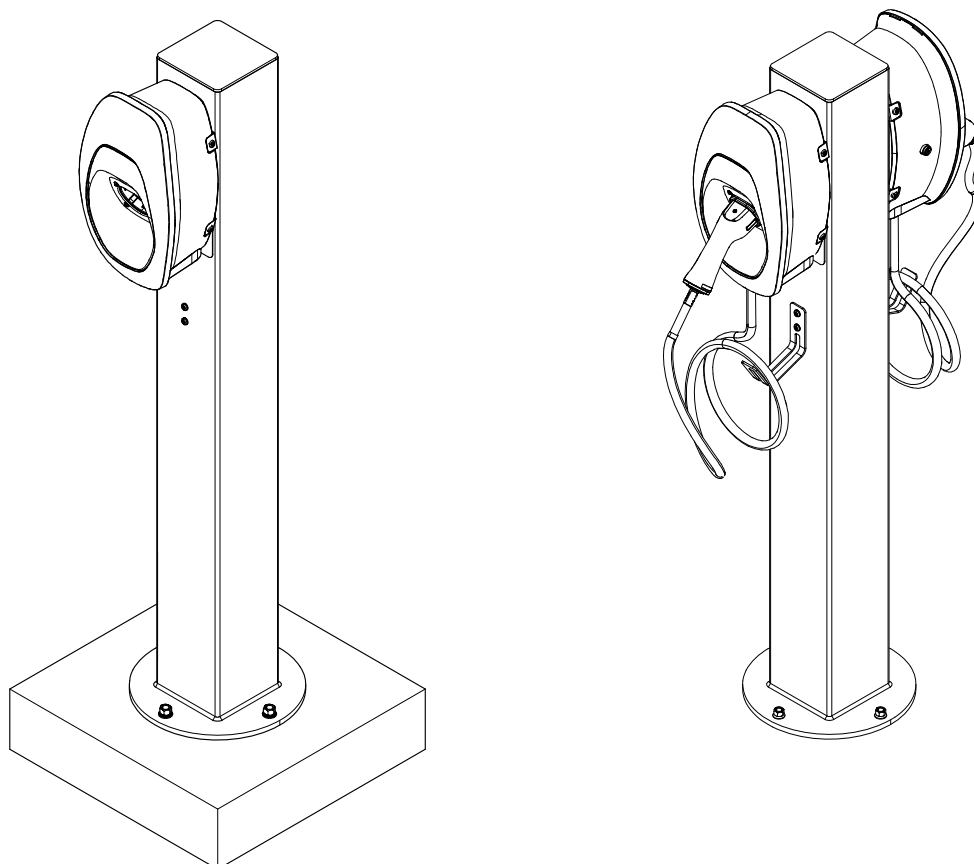



Electric Vehicle Chargers
Smart solutions for Electric Vehicle revolution



NHP EV Infrastructure Landing Page – Australia
<https://nhp.com.au/Industries-and-Solutions/Solutions/Electric-Vehicle-Chargers>



NHP EV Infrastructure Landing Page – New Zealand
<https://www.nhpnz.co.nz/Industries-and-Solutions/Solutions/Electric-Vehicle-Chargers>