

# 855BSS20BR4

Allen-Bradley 855BL Beacon 90mm Round Surface Mount  
Strobe 240V AC Full Voltage Red



**Allen-Bradley**

by ROCKWELL AUTOMATION

BEACONS



Component type	Rotating beacon alarm luminaire
Range	Beacons
Model	N/A
Product status	Existing

The Allen-Bradley 855R series of round beacons are ideal for use in industrial signalling applications. Designed for fast, flexible, and easy installation with simple modular assembly while maintaining reliable performance. Available in 110mm diameter size utilising the latest LED technology with various colour, voltage and mounting options.

## ELECTRICAL

Nominal voltage	240.0 V
Electricity consumption	0.12 A
Type of current	DC
Function	Strobe

## CONSTRUCTION

Colour of lamp hood	Red
Degree of protection (IP)	IP65
Optics	Fresnel lens
Degree of protection (NEMA)	13
Mounting method	Surface mounting

## PHOTOMETRIC

Lamp type	Other
-----------	-------

# 855BSS20BR4

Allen-Bradley 855BL Beacon 90mm Round Surface Mount  
Strobe 240V AC Full Voltage Red



**Allen-Bradley**

by ROCKWELL AUTOMATION

BEACONS

## DIMENSIONAL DIAGRAM

Dimensions in millimeters (inches). Dimensions are not intended to be used for manufacturing purposes.

90 mm Beacon NPT Conduit Mount

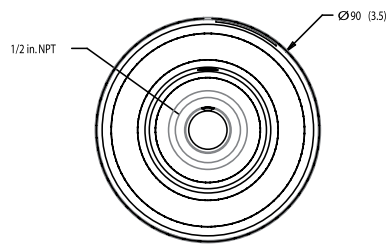
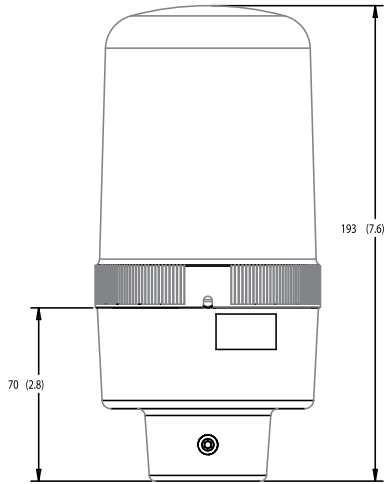

90 mm Beacon Surface Mount

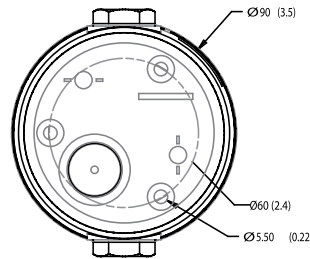
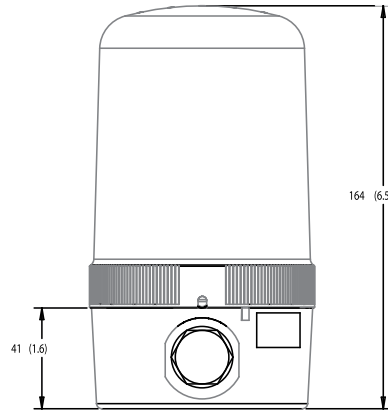

90 mm Beacon Tube Mount

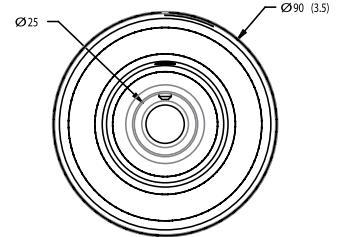
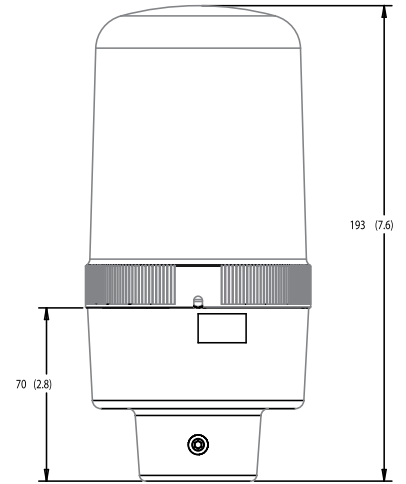

90 mm Beacon Vertical Bracket

