

800TA2

Allen-Bradley 800T Pushbutton 30.5mm Flush Head Momentary
Non Illuminated No Contacts Black



Allen-Bradley

by ROCKWELL AUTOMATION

PUSHBUTTON AND PILOT LIGHTS



Component type	Push button, complete
Range	800T/H Pushbutton
Model	N/A
Product status	Existing

The Allen-Bradley 800T/H range of 30.5mm mount operators are designed and constructed to perform in the most demanding industrial environments. The range includes pushbuttons, selector switches, emergency stops, pilot lights. Available in both metal and plastic types with a modular design allowing for easy selection, configuration and assembly of components to form the operator control device.

ELECTRICAL

Number of contacts as normally open contact	0.0
Number of contacts as normally closed contact	0.0
Type of electric connection	Screw connection

CONSTRUCTION

Colour button	Black
Type of button	Flush
With front ring	Yes
Material front ring	Metal
Degree of protection (IP)	IP65/IP66

MECHANICAL

Switching function latching	No
Shock acceleration (Max)	100.0 g
Vibration acceleration (Max)	10.0 m/s ²
Vibration frequency, operational (Max)	2000.0 Hz

PHOTOMETRIC

Suitable for illumination	No
---------------------------	----

DIMENSIONS

Hole diameter	30.5 mm
Operator diameter	34.9 mm

800TA2

Allen-Bradley 800T Pushbutton 30.5mm Flush Head Momentary
Non Illuminated No Contacts Black



Allen-Bradley

by ROCKWELL AUTOMATION

PUSHBUTTON AND PILOT LIGHTS

DIMENSIONAL DIAGRAM

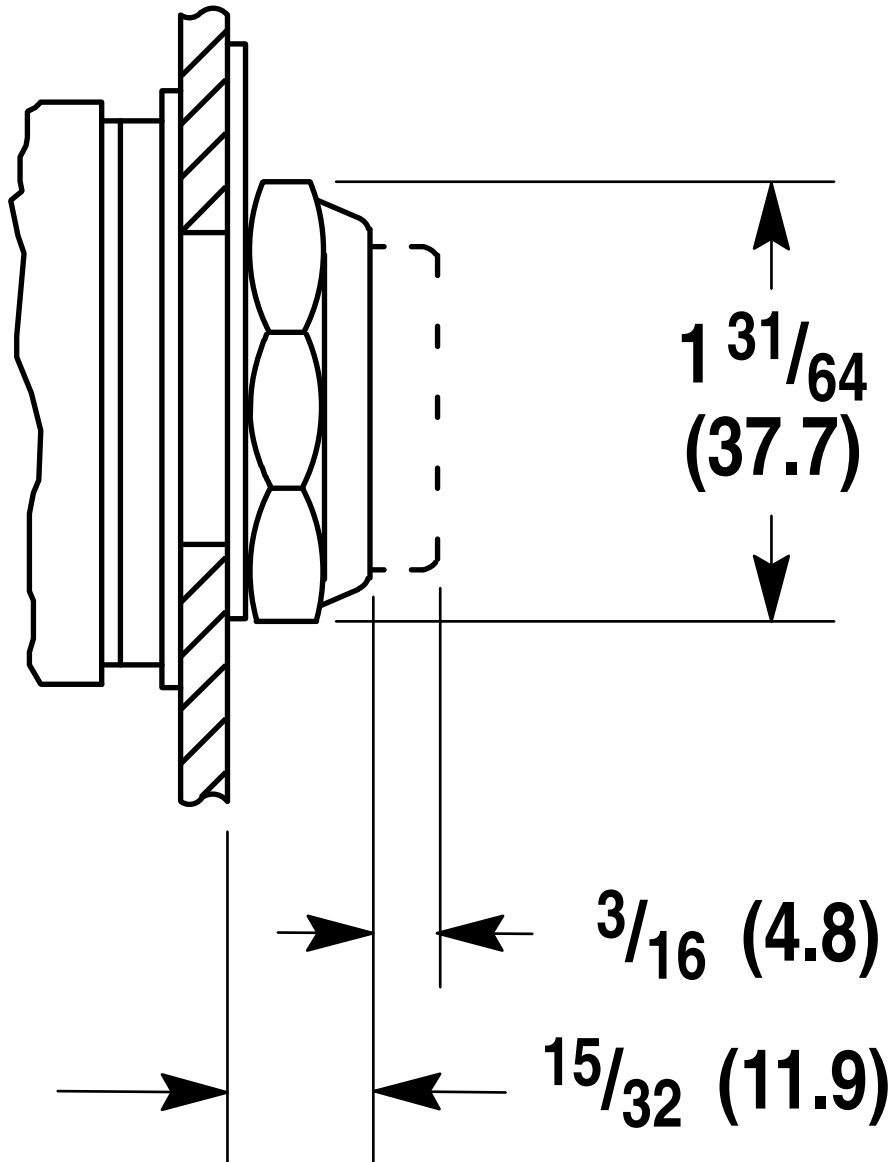

Extended
Head Only

Flush and Extended
Head Push Button

Shipping Wt. 5-1/2 oz (0.15 kg)