

# INSTALLATION INSTRUCTIONS MOULDED CASE CIRCUIT BREAKERS TEMBREAK PRO P400 3P THERMAL MAGNETIC

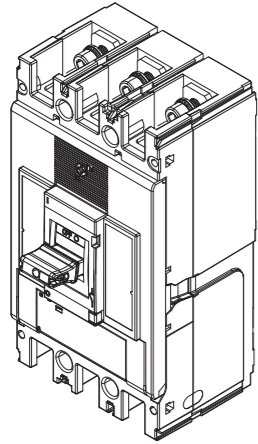

NHP Electrical Engineering Products Pty Ltd  
A.B.N. 84 004 304 812  
AUS 1300 NHP NHP | nhp.com.au  
NZ 0800 NHP NHP | nhp-nz.com

**TOOLS REQUIRED (NOT included)**

- T1 Screwdriver Flathead (5mm)
- T2 Screwdriver Phillips (#2)
- T3 19mm Socket wrench
- T4 8mm Allen key Socket wrench
- T5 19mm Ring Spanner

**HARDWARE (included)**

- A M10x30 Socket Screw (6 qty)
- B M10 spring washer (6 qty)
- C M10 flat washer (6 qty)
- D M6x100 mounting screws (4 qty)
- E Interpole Barriers (2 qty)
- Instruction Manual (This Document)

**HARDWARE (NOT included)**

- F Cable Lug or Copper Bar
- G \*M12x35 hex bolt (6 qty)
- H \*M12 flat washer (6 qty)
- I \*M12 Belleville washer (6 qty)
- J \*M12 nut (6 qty)

\*For extension bar connection only

**OPTIONAL (NOT included)**

- K Extension Bars
- L Terminal Covers
- M Terminal Cover Lock
- N Handle Lock
- Internal Accessories

**MOUNTING ANGLES**

**MOUNTING**

TORQUE 4.6 - 6 Nm

**DIMENSIONS**

**CLEARANCE**

MCCB Cat No.	Y min (mm)	Z min (mm)
P400E		80
P400F	0	80
P400N		80
P400H		80
P400S	0	80

BR<sub>1</sub>, BR<sub>2</sub> = Adjacent Isolators / MCCBs

**CLEARANCE**

INSULATION PLATE  
TOP PLATE (EARTHED METAL)

X<sub>1</sub>, X<sub>2</sub>, W\*

INSULATION

\*distance from conductor insulation to downstream MCCB

MCCB Cat No.	W* min (mm)	X <sub>1</sub> min (mm)	X <sub>2</sub> min (mm)
P400E			
P400F	100	80	60
P400N			
P400H			
P400S	120	120	80

P400\_3\_TM-IN-001-EN V1.0.0

**OPERATING INSTRUCTIONS**

Trip Button

Operation	Force (Nm)
OFF → ON	150
ON → OFF	130
TRIP → OFF	162

**DIRECTION OF POWER SUPPLY**

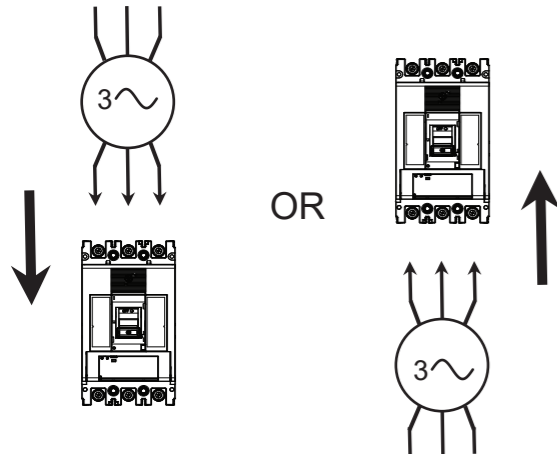

**INTERNAL ACCESSORIES ASSEMBLY PROCEDURE\***

**STEP 1 TRIP MCCB**

**STEP 2 OPEN COVER**

**STEP 3 IDENTIFY TRIP BAR & MECHANISM**

**STEP 4.1 UVT/SHUNT INSTALLATION**

**STEP 4.2 ALARM INSTALLATION**

**STEP 5 CLOSE MCCB COVER**

\*For additional internal accessory installations, scan QR code and refer to user manual for more details

CONDUCTOR CONNECTION PROCEDURE -- FRONT CONNECTION -- EXTENSION BAR CONNECTION PROCEDURE

A	M10x30 Socket screw	H	M12 Flat washer
B	M10 Spring washer	I	M12 Belleville washer
C	M10 Flat washer	J	M12 Nut
F	Lugs or copper bar	K	Extension Bars
G	M12x35 hex bolt		

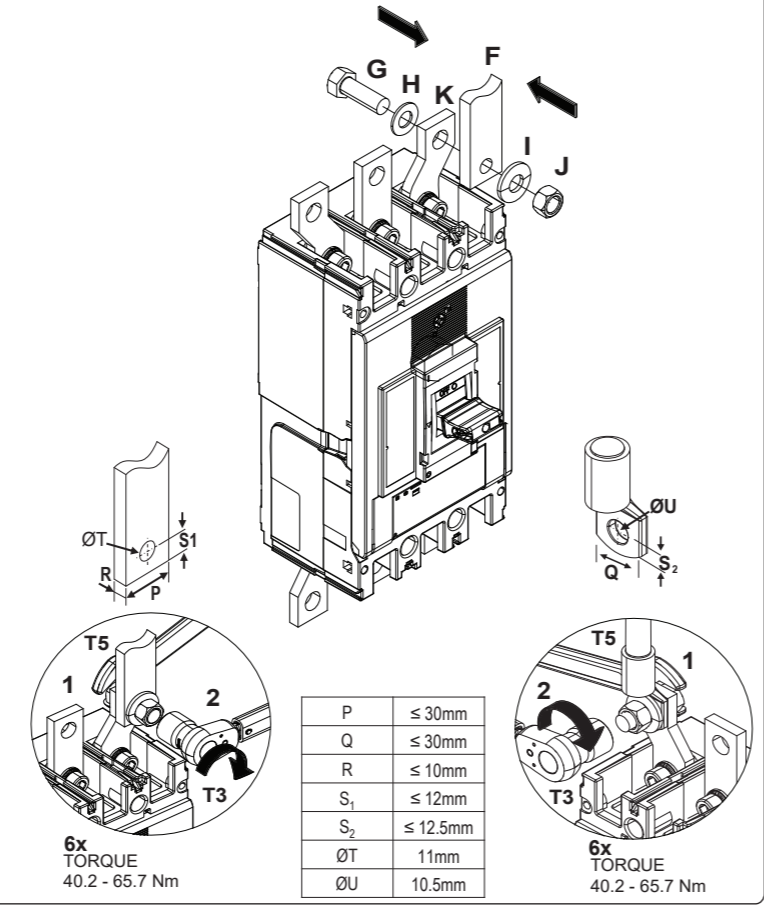
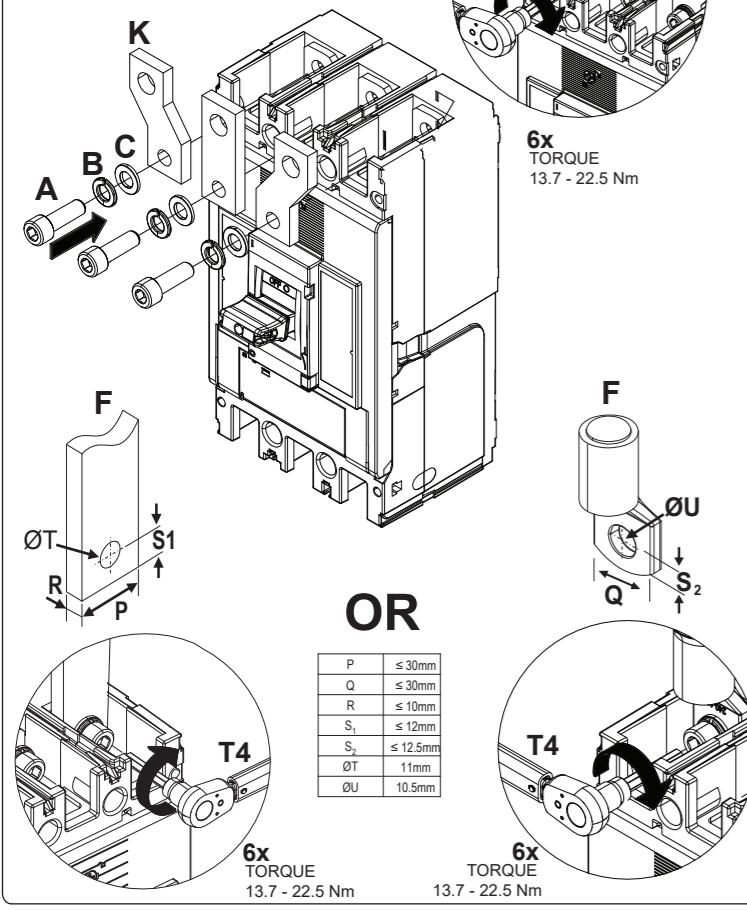

TOPSIDE INSULATION RECOMMENDATIONS – 415 / 440V AC

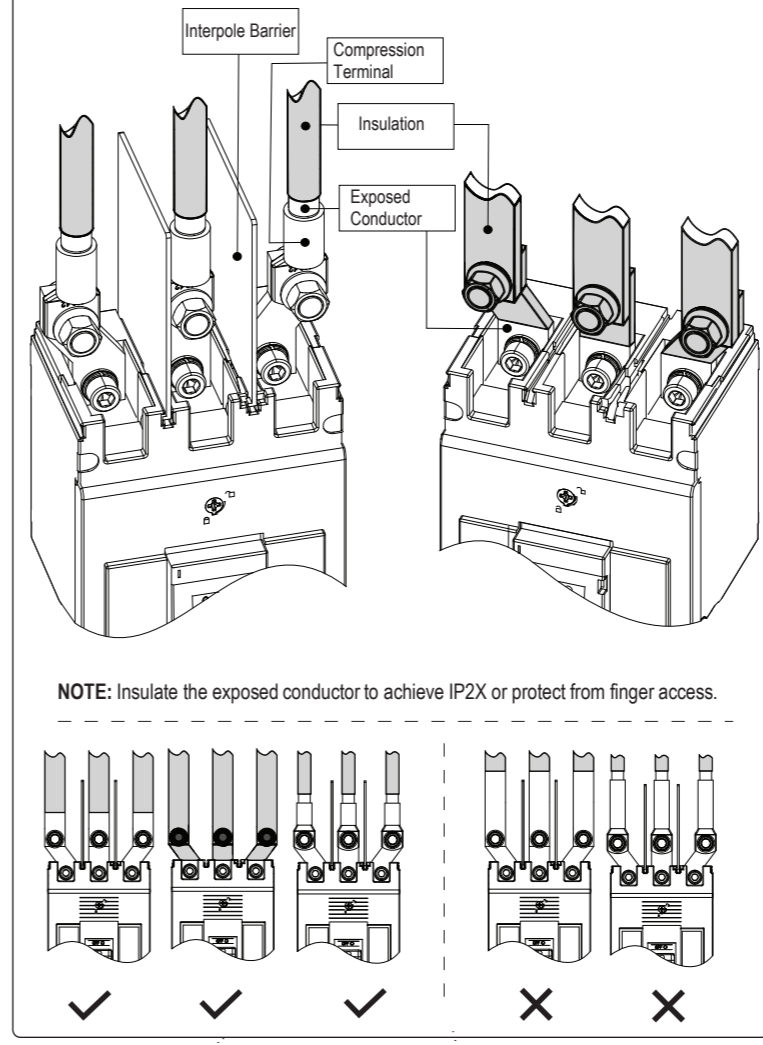

TRIP UNIT ADJUSTMENT PROCEDURE

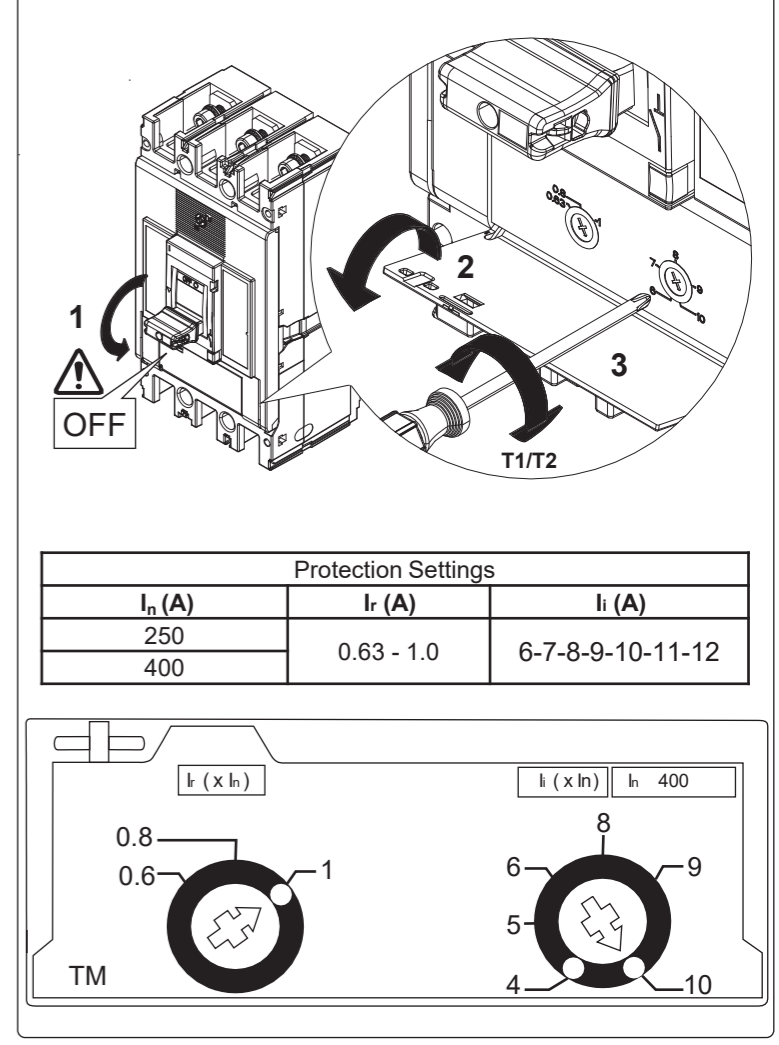

TERMINAL COVER

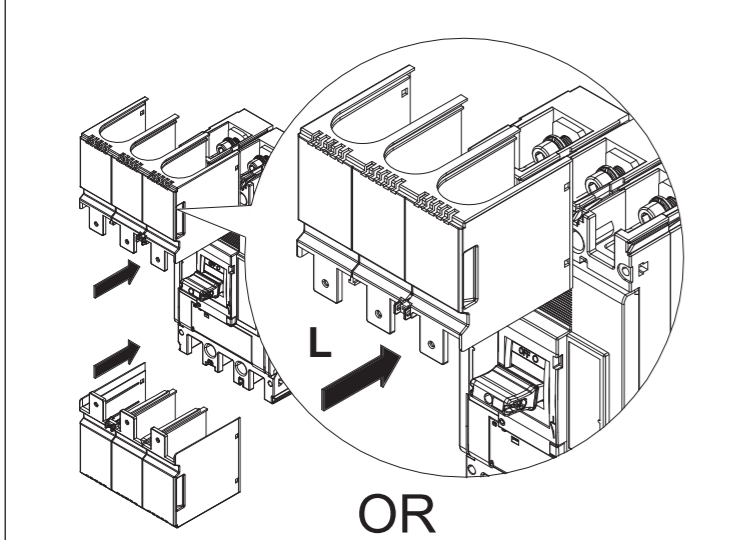

INTERPOLE BARRIER

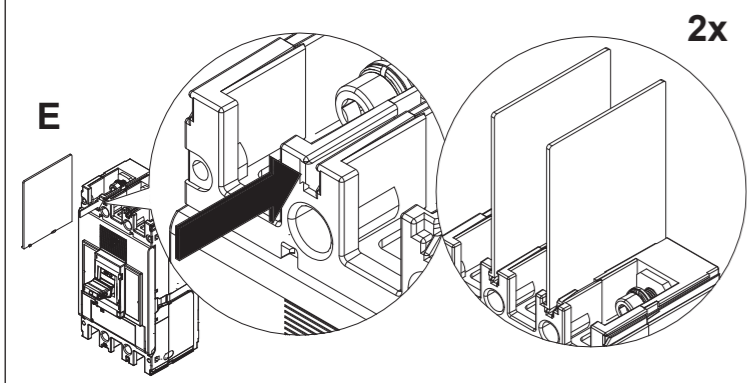

TERMINAL COVER LOCK

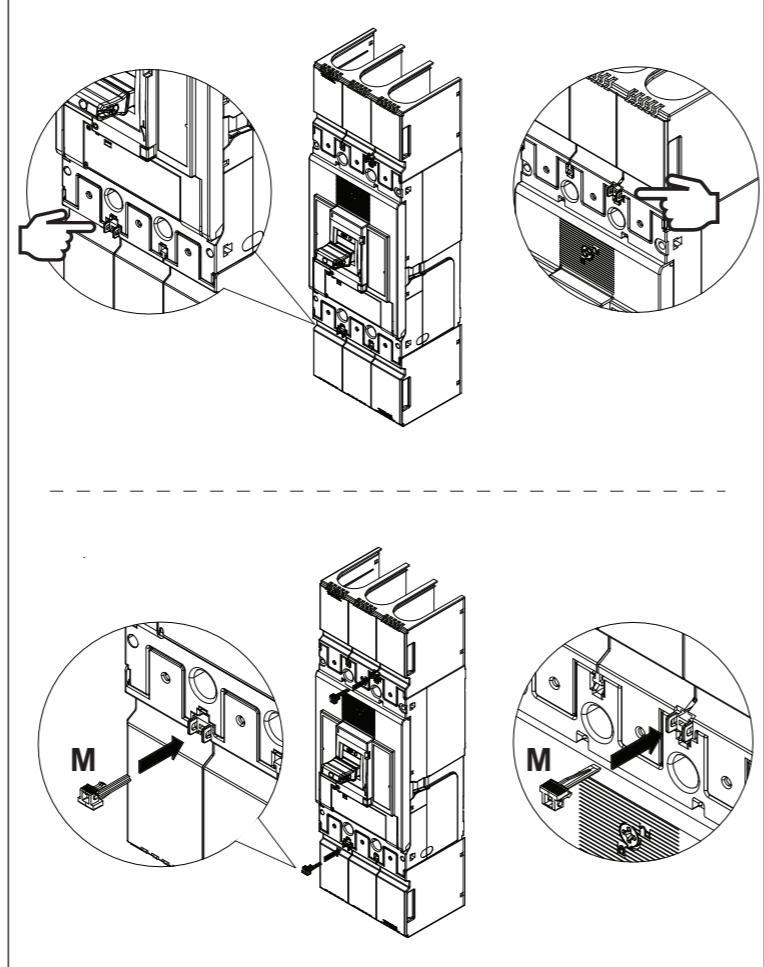

TOGGLE LOCK / PADLOCK ASSEMBLY PROCEDURE

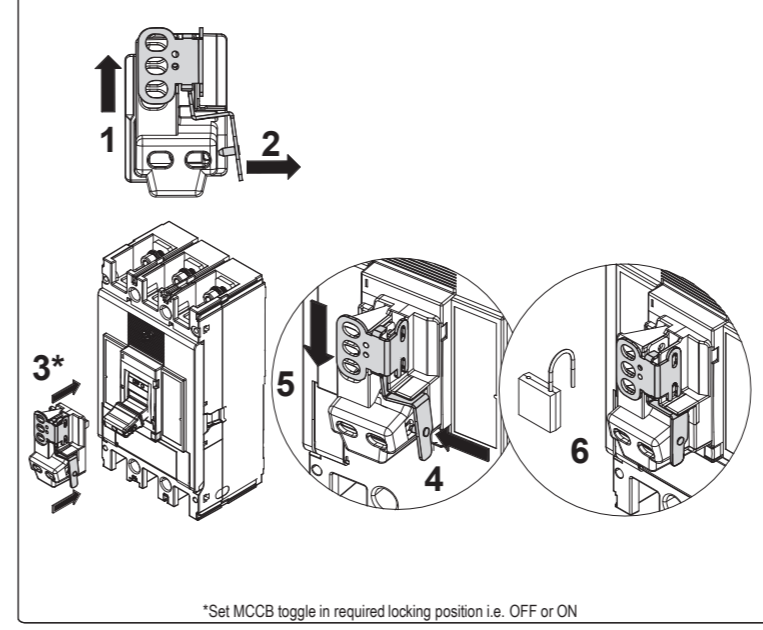

TOGGLE LOCK OPTION

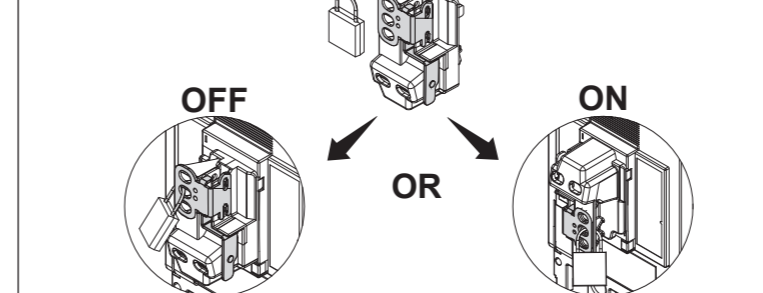

TIME CURRENT CHARACTERISTIC CURVE

